

**BUY  
ME**

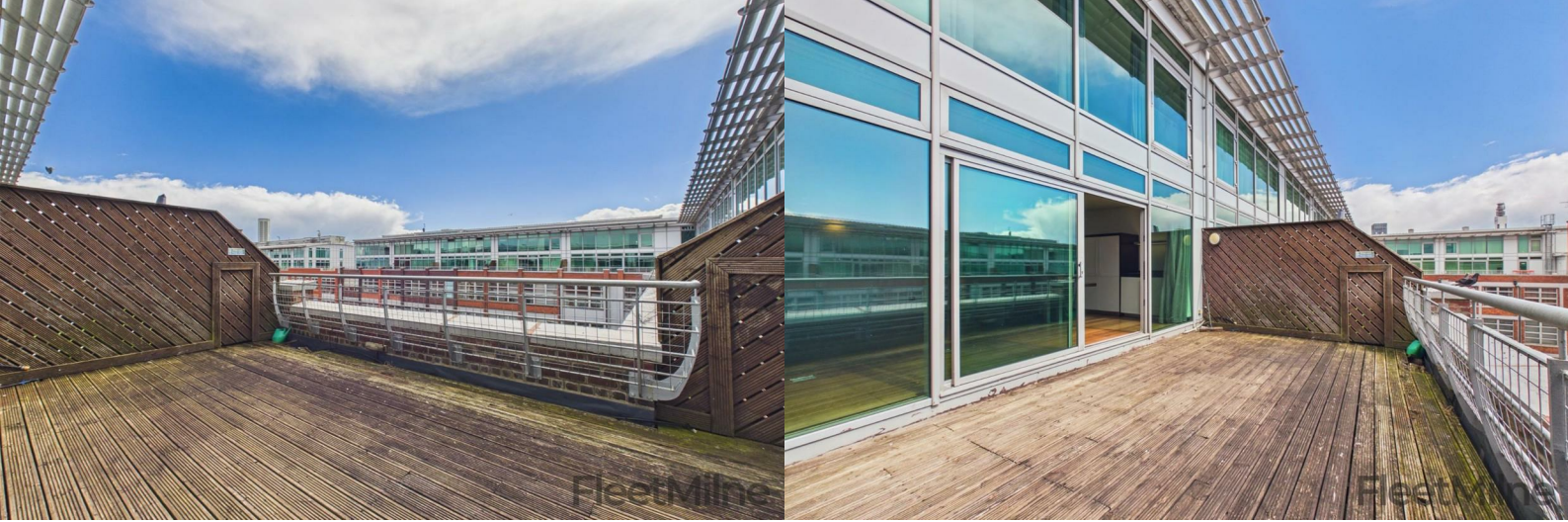

FleetMilne



**New Hampton Lofts, B18 6EU**

**£425,000**

**JEWELLERY QUARTER**

- A stunning 1700sqft duplex penthouse
- Three bedrooms, all generous doubles
- Three bathrooms, two ensembles and one main bathroom
- A secure and underground, allocated parking space
- Large private terrace
- An original, loft-style development
- Jewellery Quarter location
- Perfect for owner occupiers, or investors looking for a high-end investment
- 0.4 miles to St Paul's Square & 0.8 miles to Colmore Row
- 0.5 miles to Snow Hill Station, 0.2 to the JQ train station, and 1 mile to New Street Station, all with direct links to central London

3

3

1

[fleetmilne.co.uk](http://fleetmilne.co.uk)

0121 366 0456

**FleetMilne**